



KENSINGTON ESTATES

Churchill

2 Bedroom

2 Bath

Interior 1,569 sq. ft.

Exterior 287 sq. ft.

Basement

One Car Garage

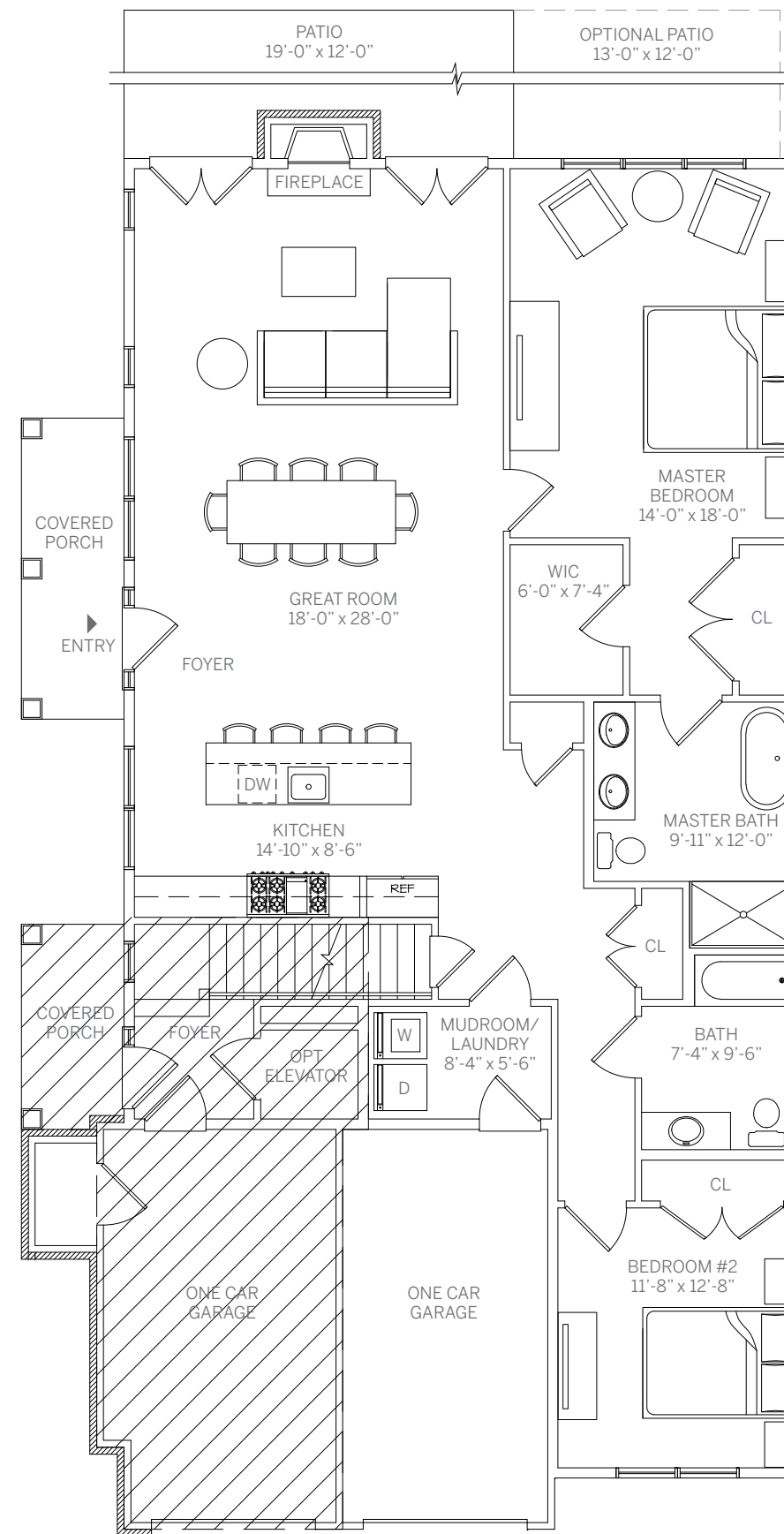

First Floor

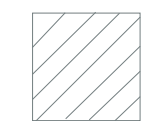

Adjacent Unit

496 Jericho Turnpike, Woodbury, NY
516.261.6116
info@KensingtonEstatesWoodbury.com

The complete offering terms are in an Offering Plan available from Sponsor. File No. CD18-0152

All floorplans and renderings are artist's conceptions and are not intended to be an actual depiction of the walls, windows, walks, driveways, landscaping, patios or decks. All dimensions, plans and elevations are approximate and subject to normal construction variances and tolerances. All square footage calculations are based on exterior wall-to-wall dimensions. All interior dimensions are based on interior wall-to-wall measurements. We reserve right to make changes due to unforeseen conditions, in accordance with the Offering Plan. This floorplan may appear in reverse.

CHURCHILL – RESIDENCE DETAILS

Carriage House – 1st Floor - 2 Bedroom, 2 Full Baths

Interior: 1,569 sq. ft.

- Single story living, first floor
- French doors to patio. Optional additional patio extension.
- Solid 3¼” oak floors throughout, 6” optional
- Crown and base moldings throughout
- Gas fireplace with stone surround
- Full 1,671 sq. ft. basement with egress window

Kitchen:

- Subzero stainless steel appliances: 36” built-in French door refrigerator, 36” 6-burner Wolf gas range, Best range hood, Cove dishwasher, Wolf microwave
- Spacious island with seating area
- 1¼” eased edge countertops
- 42” high upper cabinets with soft close doors and drawers
- Premium Kohler fixtures

Baths:

- Carrara marble floors
- Premium Kohler fixtures
- Master bath oversized separate shower
- Master bath soaking tub

Exterior: 287 sq. ft.

- Private, end unit with covered side entry and tremendous amount of natural light
- Brick and Hardie Board exterior
- 1-car garage with direct entry to home
- Andersen – 400 Series Windows
- Architectural roof shingles